

## Instructions-Replacement PC Board with motor for Series 19, 21, 22, 30, 32, 68, 75 & 76 Stack Pack

### Caution

- PC Board assembly must be used in a system having dual or redundant gas valve (except Series 21, & 22 designed for use with single gas valves.)
- To be installed only by a qualified installing agency.
- Boards are not interchangeable. Be certain you have correct replacement and follow correct instructions.
- Disconnect electrical supply to the system and allow vent piping to cool.
- Follow these instructions carefully. This device is potentially dangerous if improperly installed.
- Check out system through three complete operating cycles (see warning below).

### Remove old P.C. Board Assembly

1. Turn off power.
2. Disconnect harness connector from P.C. board.
3. Remove motor from bracket by removing 2 screws. Do this carefully. Motor is soldered to P.C. board.
4. Some models retain the P.C. Board with screws. Remove 4 screws holding P.C. board. Other models retain P.C. board with a snap in pem: gently pull board up at corners to unsnap.
5. Lift P.C. board straight up to disengage switches from damper rod cam. Align rectangular cutout in P.C. board with motor mounting bracket and tilt board to remove.

### Install New P.C. board Assembly

1. With the damper in open position, reverse procedure in step 5 to replace new board. Gently depress switch lever as P.C. board is lowered over damper rod cam to prevent damage.
2. Install 4 P.C. board screws finger tight. Push P.C. board in to depress the end switch lever and tighten screws. This sets P.C. board up for proper operating point. Snap in boards are located automatically. Gently press down at corners.
3. Using two screws removed in step 2 carefully replace motor to bracket.
4. Check unit through three complete operating cycles for proper operation. Reconnect harness connectors.

**Series 22 Only** — Connect two wires from P.C. board to the heat probe on housing.

**Series 68 Only** — Remove P.C. board from housing carefully so as not to damage capillary tube coil.

### Warning

Repair is not complete until system is checked out:

1. Restore electrical power to system.
2. Operate system through three complete cycles, checking for free damper movement. Damper movement can be seen through the guide hole in the casting directly opposite the operator.
3. On a call for heat, damper should move to full open position before burner starts.
4. Operate high limit control during "Burner On" cycle to be sure high limit is not bypassed.
5. Burner operation should cease immediately when system demand is satisfied. Damper vane should close.

### NOTES

1. Relay and motor may vary from those depicted.
2. SL30 has no relay.
3. SL32 has two relays (one for time delay).

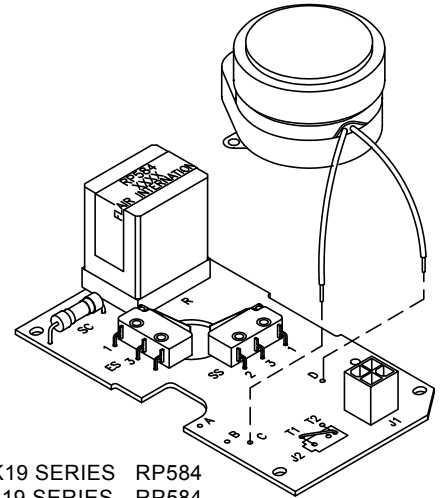

SK19 SERIES	RP584
SL19 SERIES	RP584
SL30 SERIES	RP585
SL32 SERIES	RP592
SL75 SERIES	RP584
SL76 SERIES	RP584

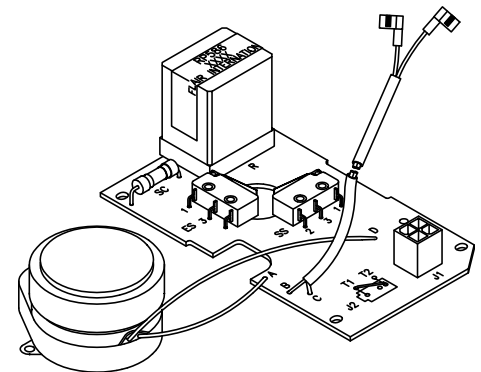

SK22 SERIES	RP586
SL21 SERIES	RP586
SL22 SERIES	RP586

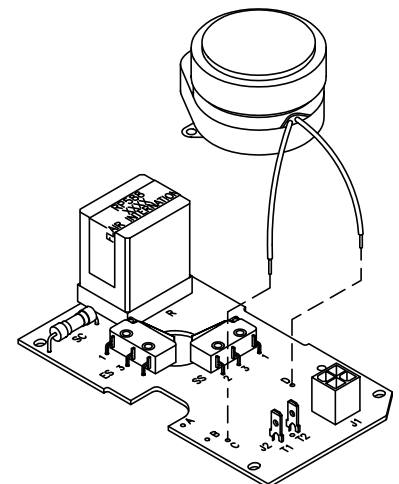

SK68 SERIES	RP588
SL68 SERIES	RP588

90704400 REV. C